



Instruction Booklet

RX-101

Please read all instructions
carefully before opening box

parallax



1

PULL YOUR PARALLAX
FABRIC OUT OF THE BOX
& UNWRAP YOUR
EXTRUSION

CAREFUL NOT TO CUT
INTO THE BAGS OR THE BOX
AS YOU COULD DAMAGE
THE FABRIC

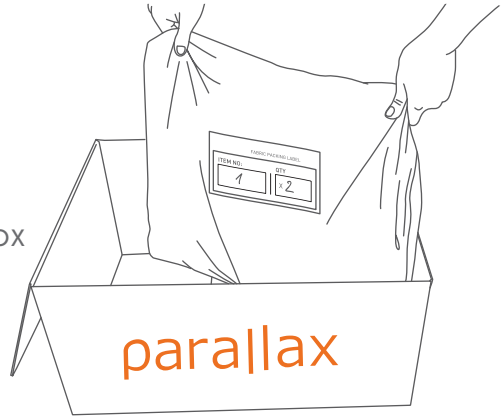

2

LINE UP THE X2 TOP CORNER
LENGTHS

NOTE: IF THERE IS NO SCREW
HOLE SIMPLY DRILL A HOLE
AS SHOWN BELOW

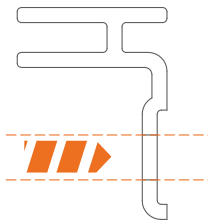
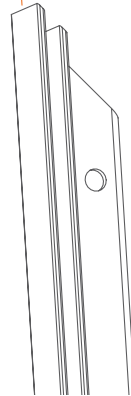
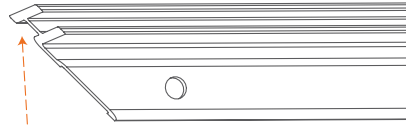

3

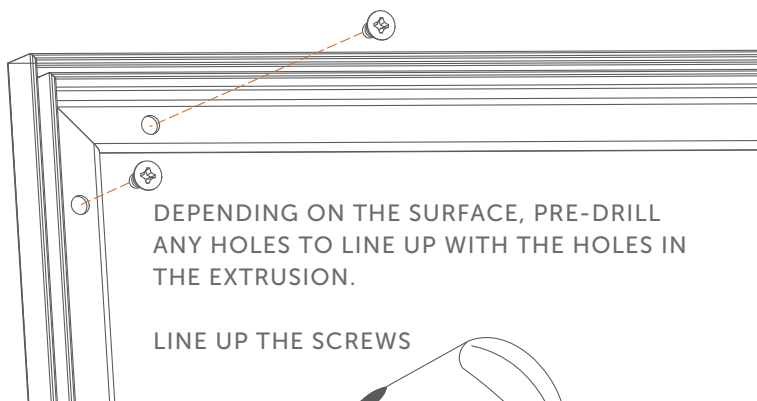

DEPENDING ON THE SURFACE, PRE-DRILL ANY HOLES TO LINE UP WITH THE HOLES IN THE EXTRUSION.

LINE UP THE SCREWS

5

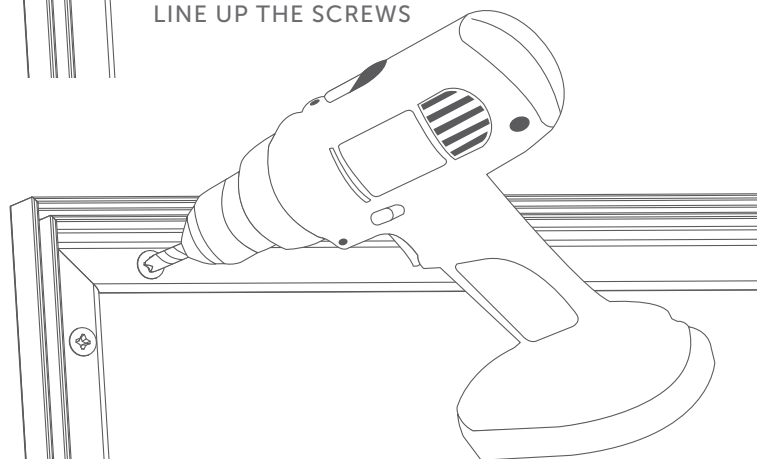

SCREW INTO PLACE AND REPEAT FOR THE OTHER LENGTHS UNTIL THE ENTIRE FRAME IS FIXED INTO PLACE.

NOTE: THE RX-101 IS SPECIALLY DESIGNED TO CATER FOR UNEVEN & UNSQUARE WALLS, IT IS NOT IMPERATIVE THAT THE MITRE LINES UP PERFECTLY ONLY THE TOP FABRIC CHANNEL ITSELF

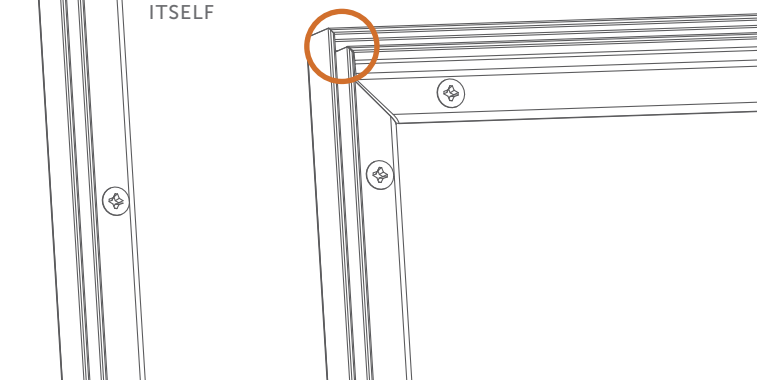

6

INSERT THE FABRIC INTO THE EXTRUSION STARTING WITH THE CORNERS ENSURE THE SILICON GASKET IS CONCEALED

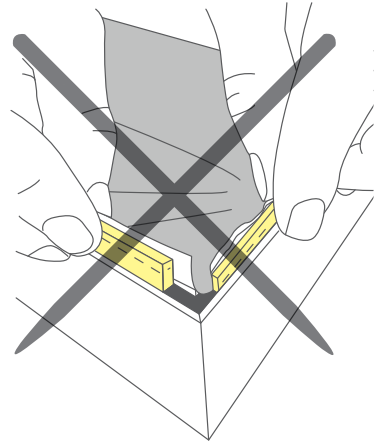
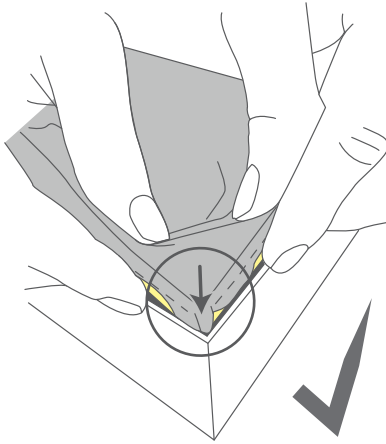

7

FOLLOW THE DIAGRAM BELOW FOR THE REMAINING SILICON GASKET EDGE.

STARTING WITH ALL CORNERS

ENSURE SILICON GASKET EDGE ON FABRIC IS PUSHED AS FAR INTO THE CHANNEL AS POSSIBLE, THIS SHOULD SUBSIDE ANY WRINKLES THAT MAY HAVE APPEARED.



Inserting Fabric

8

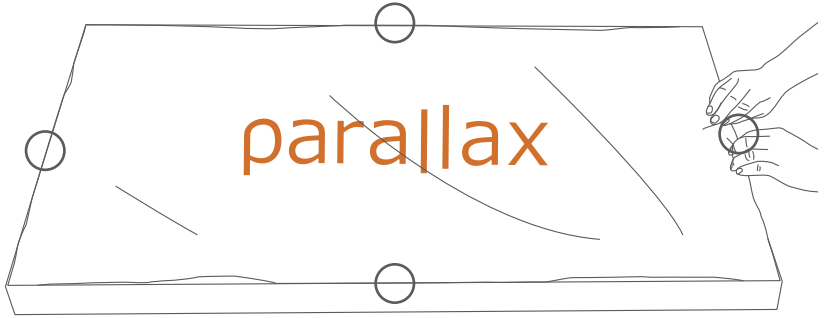

CONTINUE WITH THE MIDDLE OF EACH LENGTH,
AND THEN THE REMAINDER OF THE FABRIC

9



CONTINUE UNTIL ALL THE FABRIC HAS BEEN FULLY INSERTED